

# Instructions to Change 76 Low CFM Heater Blower Orientation

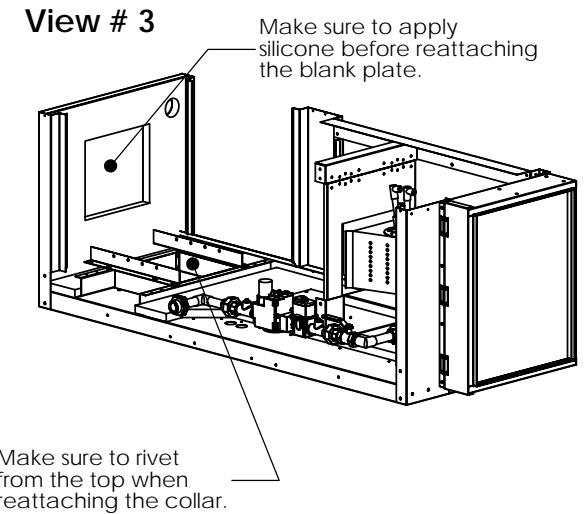

View # 4

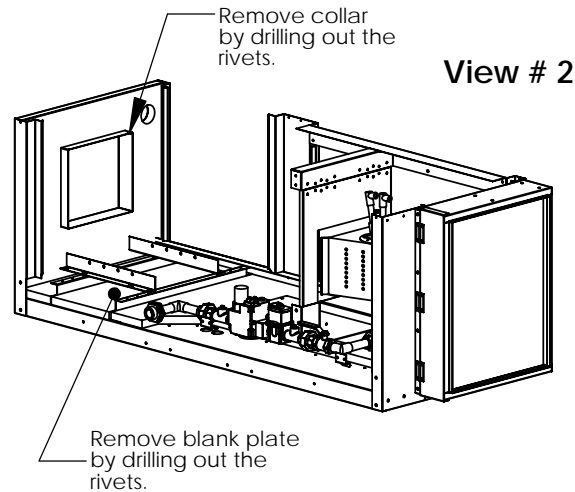
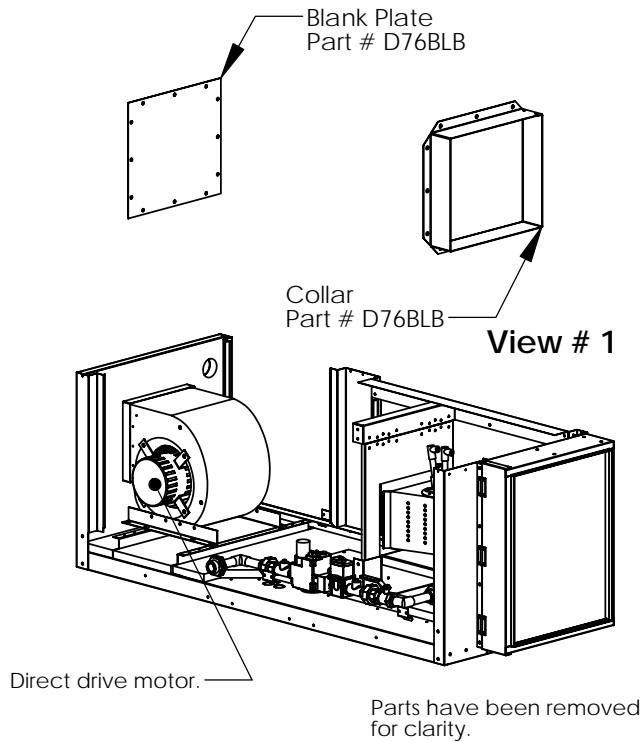
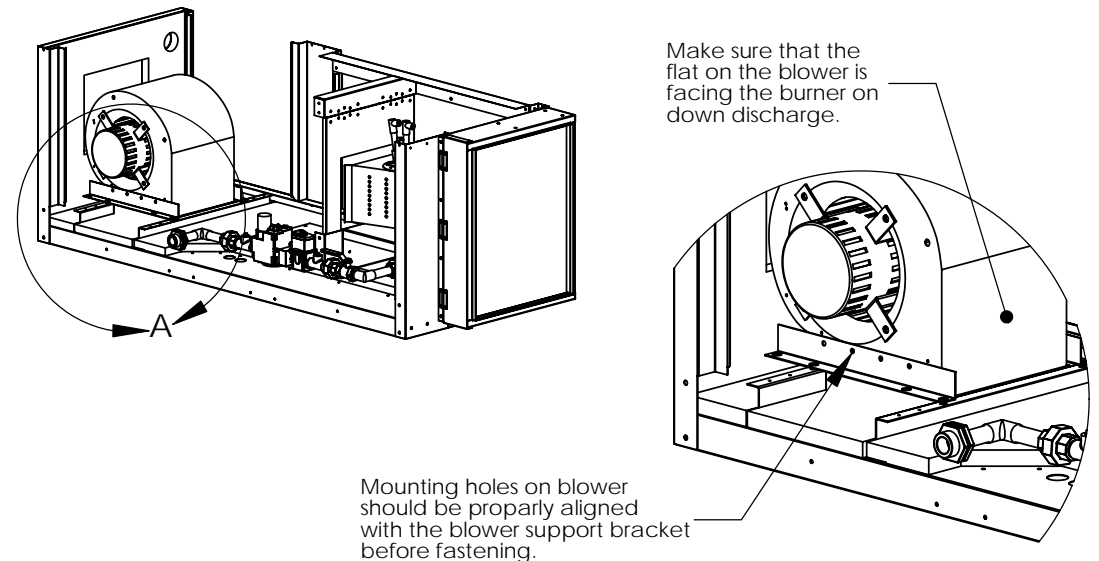

## Instructions: (for down to in-line reverse steps)

1. Disconnect power and remove blower access doors and cap.
2. Remove the fasteners that secure the blower to the blower supports, keep the hardware for future use.
3. Disconnect the motor from its power supply, remove the motor and motor plates.
4. Direct drive motors do not have to be separated from the blower.
5. Once the blower has been removed from the housing this will give you access to the collar.
6. Remove the collar by drilling out the rivets that hold it in place, you will need a 3/16" drill bit.
7. Looking under the heater you will note that there is a blank plate covering the outlet area, remove the rivets using a 3/16" drill bit.
8. Attach the blank to the front panel outlet area, make sure to use silicone before riveting the two panels together, you will need 3/16" rivets.
9. Push the collar through the base outlet and rivet from the top side of the base.
10. You can now reinstall the blower, take note of the orientation of the blower in view #5, the holes in the blower outlet will match up with the holes in the blower support. Use the screws that you removed from step 2.
11. Remount the motor, belt and pulleys, make sure you have the proper pulley alignment and belt tension before reconnecting the power supply.
12. Turn disconnect switch on, check the rotation of the blower wheel, make sure that all hardware is secure before attaching the cap and access doors.