

H2000 MOUNTING INSTRUCTIONS ON S3G

FOR WALL SUPPLY APPLICATION AND ROOF TOP EXHAUST APPLICATION

ITEM	DWG. NO.	DESCRIPTION	QTY
1	85-020598-00B	ACTUATOR: H2000A OR H2024A	1
2		BALLJOINT: 5/16	2
3		TIE ROD: 5/16" DIA 9" LG.	1
4		TEK SCREW: #10-16 X 3/4" LG. HWH	2
5	76-004354-00B	CRANK ARM:	1
6		CARRIAGE BOLT: 5/16-18 x 1 1/2" LG.	1
7		WHIZ-LOCK NUT: 5/16-18	1
8	71-021399-00B	MOUNTING BRACKET	1
9		#10-32x1/2LG HX. HD. MACHINE SCREW	3
10	71-021357-00B	MOUNTING BRACKET (FOR ACTUATOR)	1
11		#10-32 HEX NUT	3
12		SHAFT: 1/2" DIA x 5" LG (PLTD)	1
13		SET COLLAR: 1/2" BOSTON GEAR OR EQUAL	1
14		TRUARC RING: E25	4
15	78-020044-00B	BLADE BRACKET	2
16	78-020045-00B	MULTI-SECTION CONECTING LINKAGE	1
17	78-020045-00B	#10-24 X 1/2" LG. SELF TAPPING SCREW	4

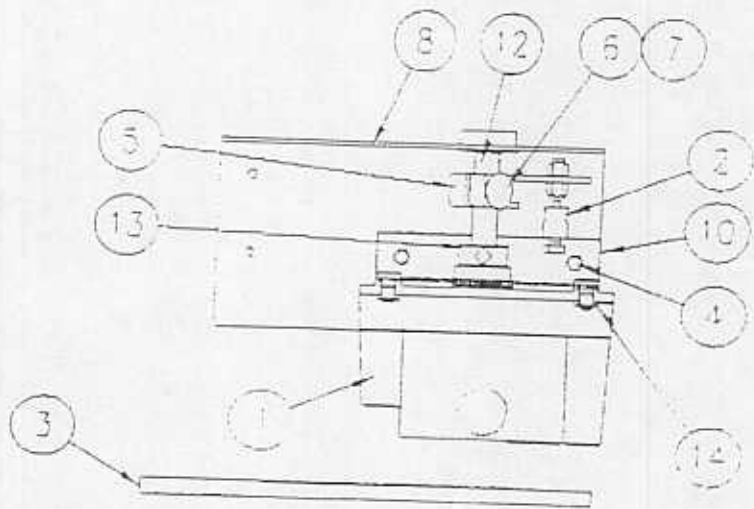

GV. FILE

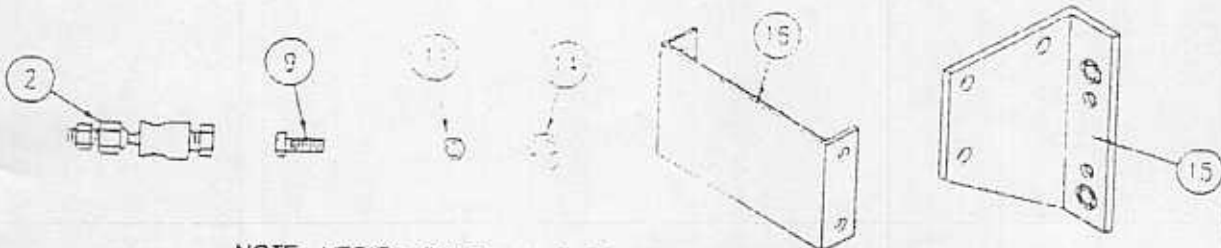

NOTE: VERIFY THAT ALL PART ARE INCLUDED IN PARTS KIT.

H:\11\11-020189-003.dwg, 03/09/01 02:42:41 PM

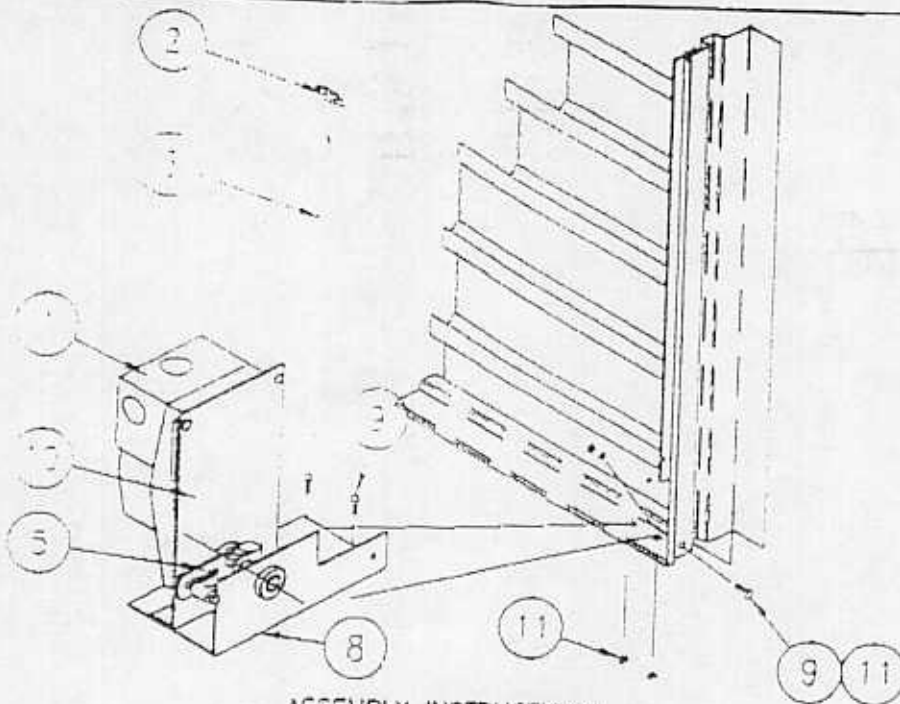

ASSEMBLY INSTRUCTIONS:

1. SCREW MOUNTING BRACKET (ITEM #8) TO ACT. MOUNTING BRACKET (ITEM #10) WITH (2) #10 TEK SCREWS (ITEM #4)
2. SLIDE 1/2" DIA. SHAFT (ITEM #12) THRU ONE BEARING ON MOUNTING BRACKET.
3. SLIDE CRANK ARM (ITEM #5) AND SET COLLAR (ITEM #13) ONTO 1/2" DIA. SHAFT. SET COLLAR SHOULD BE AGAINST THE BEARING ON ACT. MOUNTING BRACKET (ITEM #10). BOTH ITEMS SHOULD BE IN BETWEEN MOUNTING BRACKET ASSEMBLED IN STEP #1.
4. PUSH 1/2" DIA. SHAFT THRU REMAINING BEARING.
5. INSTALL ACTUATOR ONTO 1/2" DIA. SHAFT. PLACE (2) E25 TRIARC RINGS (ITEM #14) ONTO THE PINS LOCATED ON ACT. MTG. BRACKET (ITEM #10) TO RETAIN ACTUATOR. TIGHTEN ACTUATOR SET SCREWS TO 1/2" DIA. SHAFT. MAX. TORQUE FOR SET SCREWS IS 80 IN/LBS MAX.
6. INSTALL 5/16 CARRIAGE BOLT AND WHIZ-LOCK NUT (ITEMS 6 & 7) ONTO CRANK ARM (ITEM #5) DO NOT TIGHTEN. INSTALL 5/16 BALL JOINT (ITEM #2) ONTO CRANK ARM. TIGHTEN LOCATING APPROX. 1 5/8" FROM CENTER LINE OF 1/2" SHAFT.
7. USE BLADE BRACKET (ITEM #15) AS A TEMPLATE. LOCATE THE BLADE BRACKET ON THE THIRD BLADE FROM BOTTOM (NOTE THE BRACKET FITS OVER THE DIMPLES ON THE BLADE). MARK AND DRILL (2) 3/16" DIA. HOLES IN THE BLADE UNITS WITH A MULLION. DRILL BLADE THAT IS ADJACENT TO THE BLADE JUST DRILLED.
8. INSTALL ACTUATOR BRACKETS W/ ACTUATOR ONTO LOWER RIGHT HAND CORNER OF DAMPER. SECURE TO DAMPER W/ (2) #10-32 MACHINE SCREWS W/ NUTS (ITEMS #9 & #11).
9. ATTACH BLADE BRACKET (ITEM #15) TO BLADE PREVIOUSLY DRILLED WITH (2) #10-32 X 1/2" LG. SCREWS AND LOCK NUTS (ITEMS #9 & #11). UNITS WILL MULLION. CONNECT BLADE BRACKETS TOGETHER WITH LINKAGE BRACKET (ITEM #16) AND (4) #10 SELF DRILLING SCREWS (ITEM #17)
10. INSTALL BALL JOINT (ITEM #2) ONTO BLADE BRACKET (ITEM #15).
11. ROTATE ACTUATOR CRANK ARM TO PARALLEL TO DAMER. TIGHTEN 5/16 HEX BOLT. SLIDE 5/16 DIA. ROD (ITEM #3) THRU BOTH BALL JOINTS AND TIGHTEN BALL JOINTS.
12. CONNECT ELECTRICAL WIRING TO ACTUATOR. ALL WIRING MUST COMPLY WITH APPLICABLE NATIONAL AND LOCAL CODES.
13. CYCLE DAMPER/ ACTUATOR ASSEMBLY TO ENSURE PROPER OPERATION.

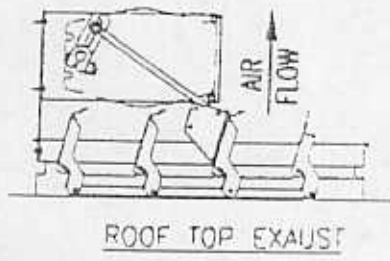

ROOF TOP EXHAUST

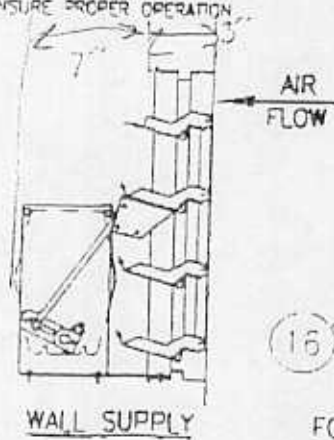

WALL SUPPLY

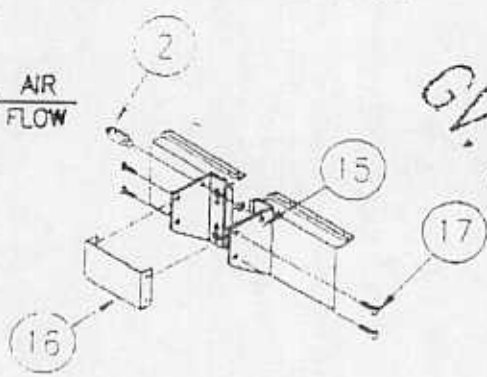

FOR MULTI-SECTION UNITS

GV-FILE

DRAWING 020189-001 dwg. 03/08/01 02:58:43 PM

RUSKIN

1-227 P 02/04 F-020

010-71-001

FROM-RUSKIN OEV DEPT

MAR-08-01 12:44